

# SLP<sub>50Hz</sub>

## In-line Circulator Pumps

SLP Series is Vertical in-line Centrifugal pump in-line port position with flange designed according to DIN Standard. Standard pumps are fitted with motor according to IEC standard, with three phase premium efficiency (IE3).



**SLP**
**General Data**

Model Code	1
Applications	1
Features	1
Pumped Liquids	1
Operation Conditions	1
Motor	1
Codes for shaft seal	1
Performance range	2
Motor Data	2

**Series 200 Materials Technical Data**

SLP 32	4
SLP 40	6
SLP 50	8
SLP 65	10
SLP 100	15

**Series 300 Materials Technical Data**

SLP 50	13
SLP 65	15
SLP 80	17
SLP 100	20

**SLP In-line Circulator Pumps**

SLP Series is Vertical in-line Centrifugal pump, in-line port position with flange designed according to DIN Standard. Standard pumps are fitted with motor according to IEC standard, with three phase premium efficiency (IE3).

### Applications

- Hot or chilled water circulating systems
- Refrigerating systems
- Domestic and potable water system
- Industrial Water services
- Circulation and supply of potable, domestic, sanitary, brackish water, and other clean aggressive liquids.

### Pumped Liquids

The pump is suitable for thin, clean, non-aggressive and non-flammable liquids, not containing solid particles or fibres that may attack the pump mechanically or chemically.

### Operation Conditions

- Flow Rate : Up to 132 m³/h
- Head : Up to 35 m
- Liquid Temperature Range : -25 To +120 °C
- Maximum Ambient Temperature : +50 °C
- Maximum Operating Pressure : 16 (bar)

### Motor

The motor fitted on SLP pumps is a totally enclosed, fan-cooled motor with main dimensions to IEC and DIN standards.

Electrical tolerances to IEC 60034.

- Relative humidity : Maximum 95 %
- Enclosure class : IP55
- Insulation class : F

### Features

- Optimised Hydraulics For High Efficiency  
Reduced power consumption.
- High-efficiency Motors  
SLP pumps are fitted with high-efficiency motors.
- High-efficiency motors offer reduced energy consumption.  
SLP pumps are primarily fitted with motors that meet the legislative requirements of the EuP IE3 grade.
- Top-pull-out Design  
Easy dismantling in case of service.
- In-line Design  
Contrary to end-suction pumps, in-line pumps allow straight pipes and thus often reduced installation costs.
- Pump Housing And Pump Head Are Electrocoated To Improve The Corrosion Resistance

### Model Code

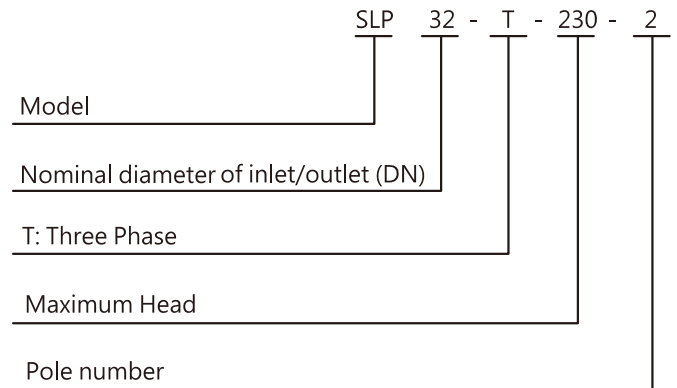

### Codes for shaft seal

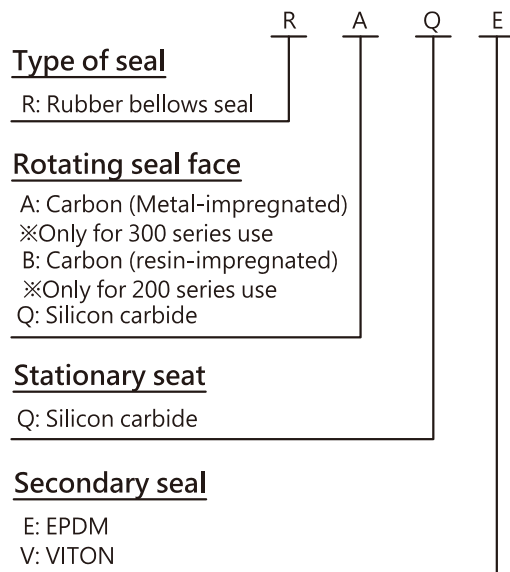

### Mechanical Seals

SLP		
Seal Type	Series 200	Series 300
RBQE	●	-
RAQE	-	●
RQQE	○	○
RBQV	○	-
RAQV	-	○
RQQV	○	○

● Std. ○ Opt. - N/A

Performance range

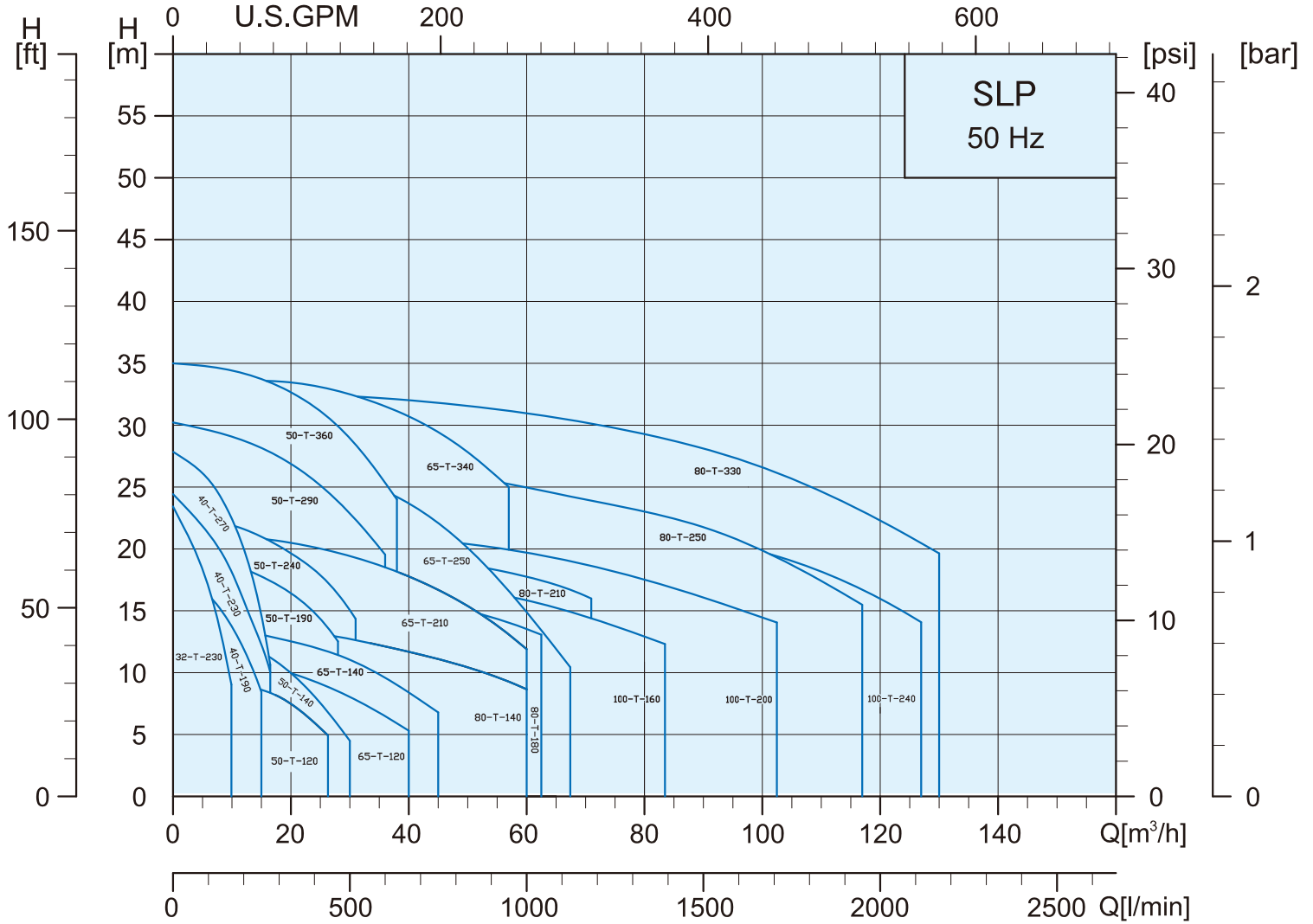

Motor Data

Series 200 Motor Type				Nominal current in [A]				IE class	
Pole	HP	kW	Flange	Frame	3Ø				
					Δ220-240V	Y380-415V	Δ380-415V		Y660-720V
2	1.0	0.75	B14 / V18	80A	3.4-3.4	2.0-2.0	—	—	IE3
	1.5	1.1		80B	4.7-5.0	2.7-2.9	—	—	IE3
	2.0	1.5		90S	5.9-6.0	3.4-3.5			IE3

Series 300 Motor Type				Nominal current in [A]				IE class	
Pole	HP	kW	Flange	Frame	3Ø				
					Δ220-240V	Y380-415V	Δ380-415V		Y660-720V
2	2.0	1.5	B5 / V1	90S	5.9-6.0	3.4-3.5			IE3
	3.0	2.2		90L	8.5-8.3	4.9-4.8			IE3
	4.0	3.0		100L	11.4-11.2	6.6-6.5	6.4-6.0	3.7-3.5	IE3
	5.5	4.0		112M	14.9-15.1	8.6-8.7	8.5-8.2	4.9-4.7	IE3
	7.5	5.5		132S	19.7-19.4	11.4-11.2	11.3-10.9	6.5-6.3	IE3
	10.0	7.5		132S	26.3-25.4	15.2-14.7	15.3-15.2	8.8-8.7	IE3
	15.0	11		160M	38.8-39.1	22.4-22.6	21.8-22.0	12.6-12.7	IE3

**Series 200 Materials**

Construction:

SLP Series 200 pumps are single-stage, close-coupled pumps with in-line inlet and outlet ports of identical diameter.

The pumps are fitted with a fan-cooled asynchronous motor.

Motor and pump shafts are connected via a rigid two-part coupling.

The pumps are of the top-pull-out design, that is you can remove the power head (motor, pump head and impeller) for maintenance or service while the pump housing remains in the pipe.

The pumps are equipped with Two types of unbalanced mechanical shaft seals are available as standard RBQE

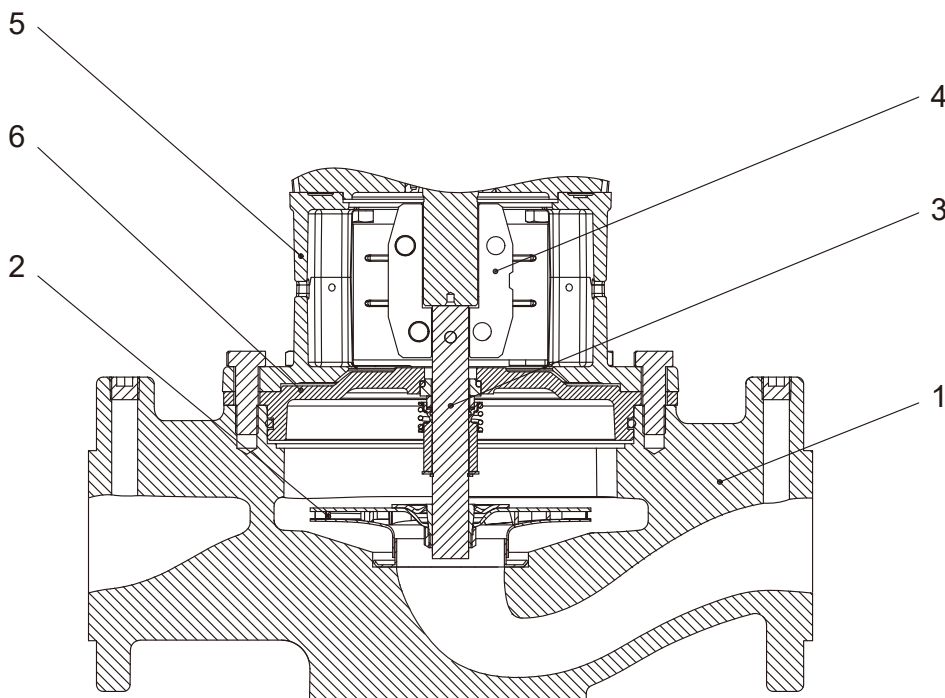

Pos.	Component	Material	EN/DIN
1	Pump housing	Cast iron FC250	0.6025
2	Impeller	Stainless steel	1.4301
3	Shaft	Stainless steel	1.4301
4	Coupling	Fe-Cu-C FC0525 (MPIF) Cast iron FCD450	0.7045
5	Pump head	Cast iron FC250	0.6025
6	Pump head cover	Cast iron FC250	0.6025
	Secondary seals	EPDM VITON	
	Rotating seal face	Carbon (resin-impregnated) silicon carbide	
	Stationary seat	silicon carbide	

Performance Curves

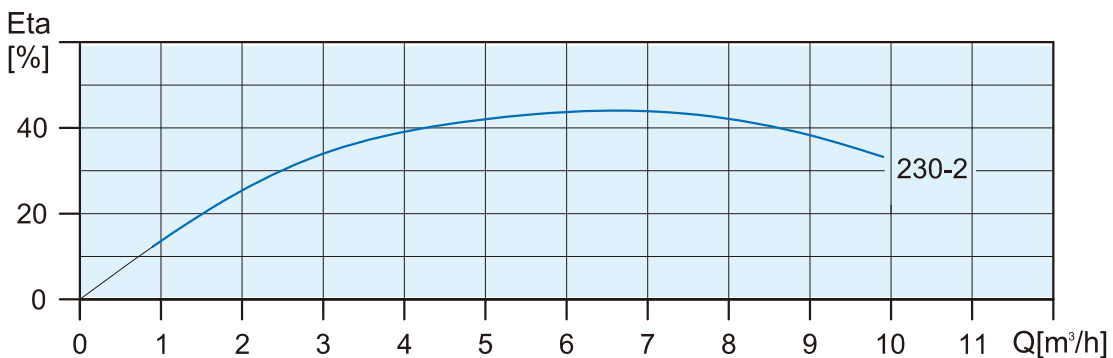
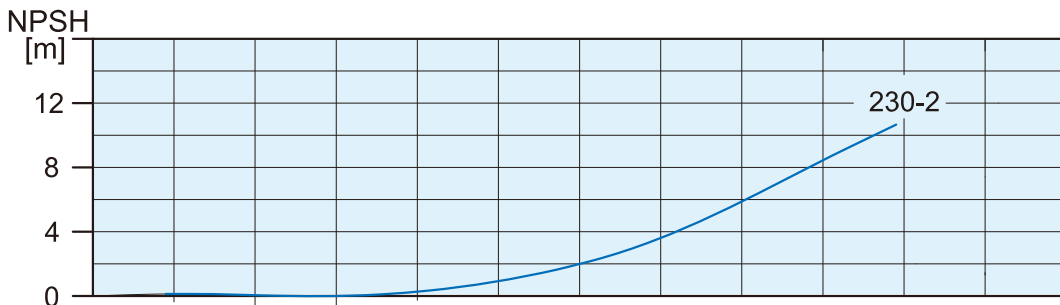
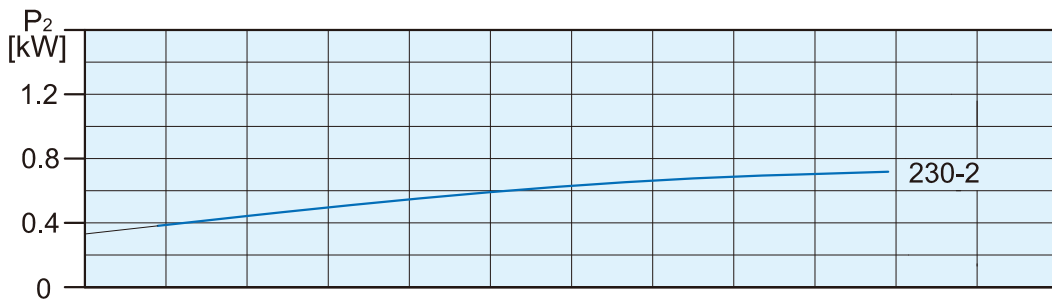
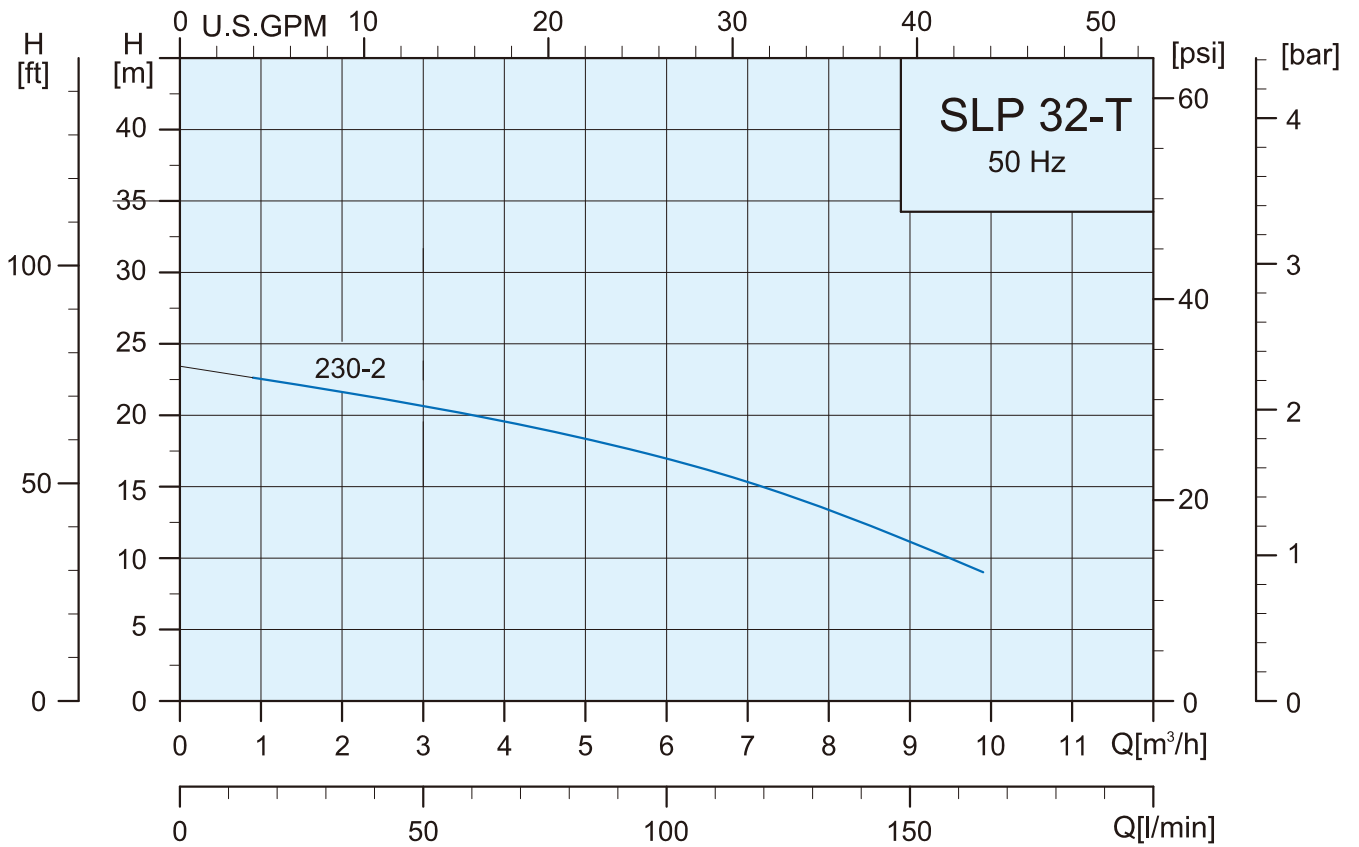

### Specifications

Model	Power		Head (Pressure)		Flow (Capacity)	Connection	T <sub>min</sub> / T <sub>max</sub>
	P <sub>2</sub>		Rated(m)	Max.(m)	Rated(m <sup>3</sup> /h)	Inlet / Outlet	°C
	kW	HP					
SLP 32-T-230-2	0.75	1.0	17.0	23.0	6.6	DN32	-25 / 120

### Dimensions and Weights

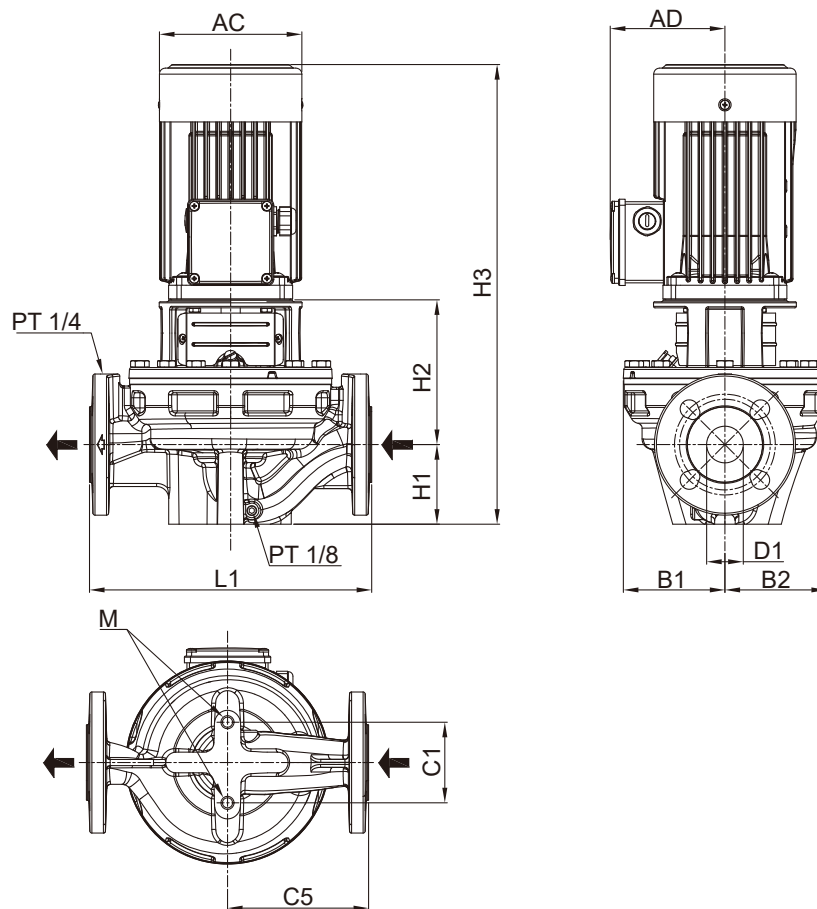

Model	Series	Flange		Dimension (mm)												Net Weight (kg)
		DIN	JIS	D1	AC	AD	B1	B2	C1	C5	L1	H1	H2	H3	M	
SLP 32-T-230-2	200	PN 6/10	10K	32	141	115	101	101	80	140	280	79	145	457	M12	26

\*The flange itself is not standard ANSI flange, but designed to be able to connect with ANSI flange.

Performance Curves

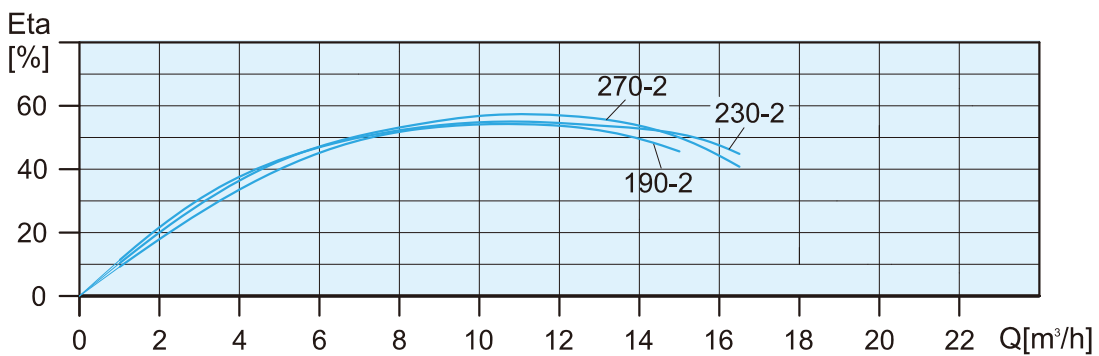
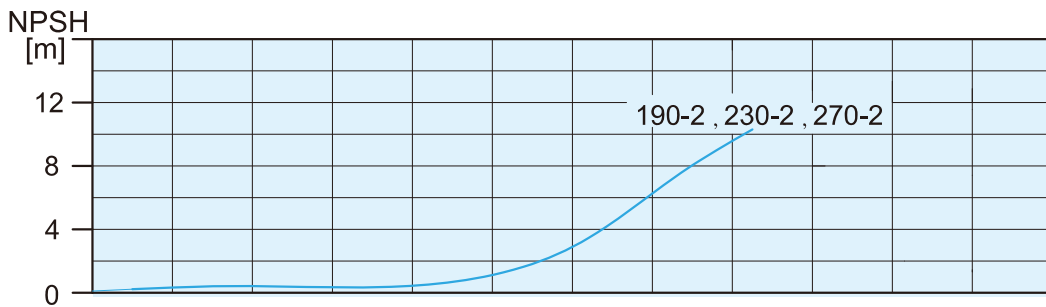
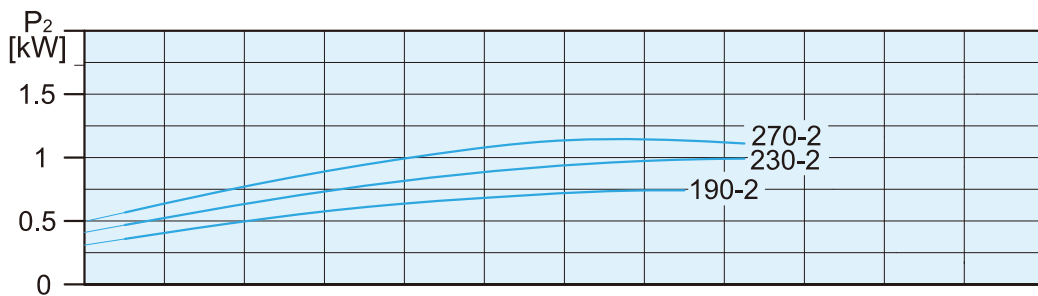
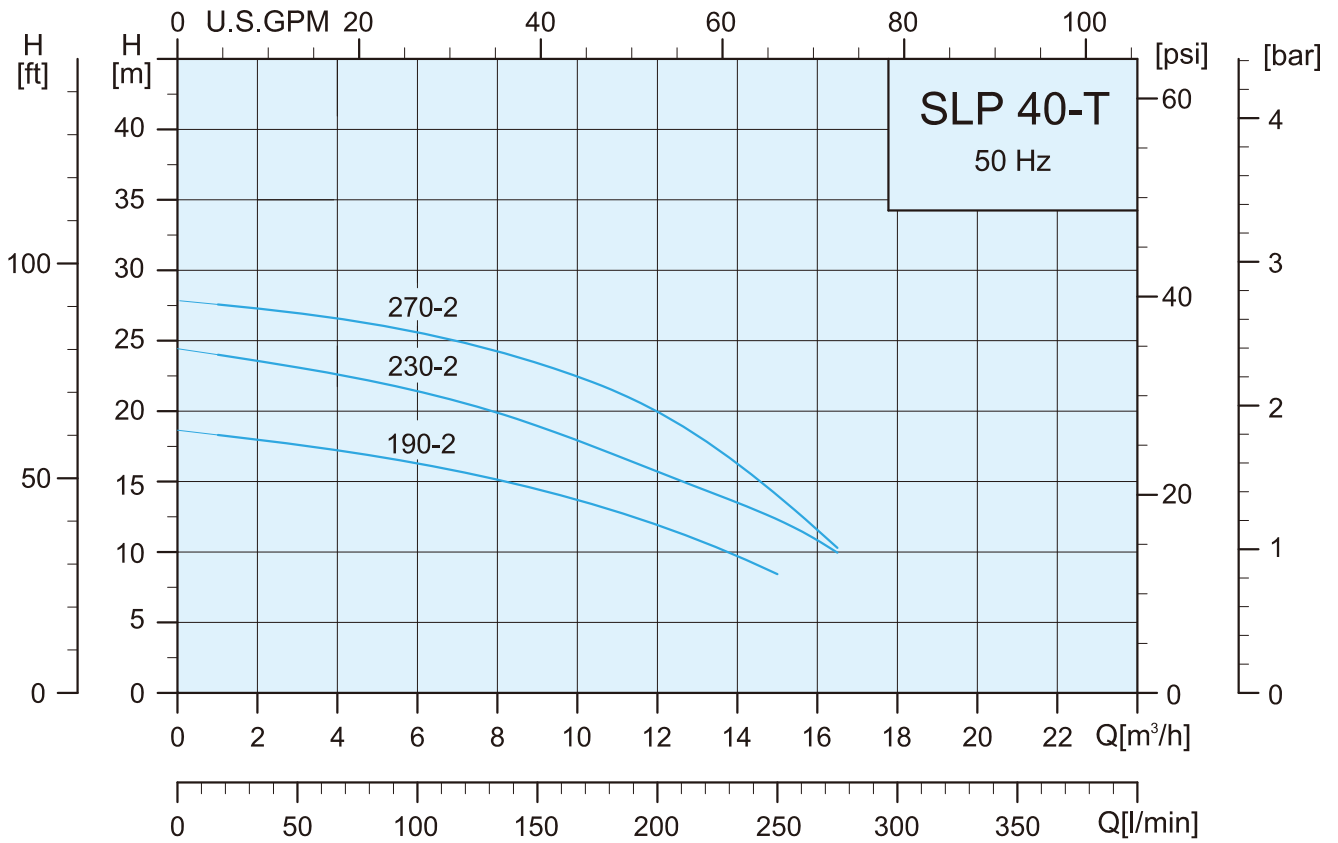

### Specifications

Model	Power		Head (Pressure)		Flow (Capacity)	Connection	T <sub>min</sub> / T <sub>max</sub>
	P <sub>2</sub>		Rated(m)	Max.(m)	Rated(m <sup>3</sup> /h)	Inlet / Outlet	°C
	kW	HP					
SLP 40-T-190-2	0.75	1.0	13.3	19.0	10.8	DN40	-25 / 120
SLP 40-T-230-2	1.1	1.5	16.5	24.0	12.0	DN40	-25 / 120
SLP 40-T-270-2	1.5	2.0	19.9	27.0	12.5	DN40	-25 / 120

### Dimensions and Weights

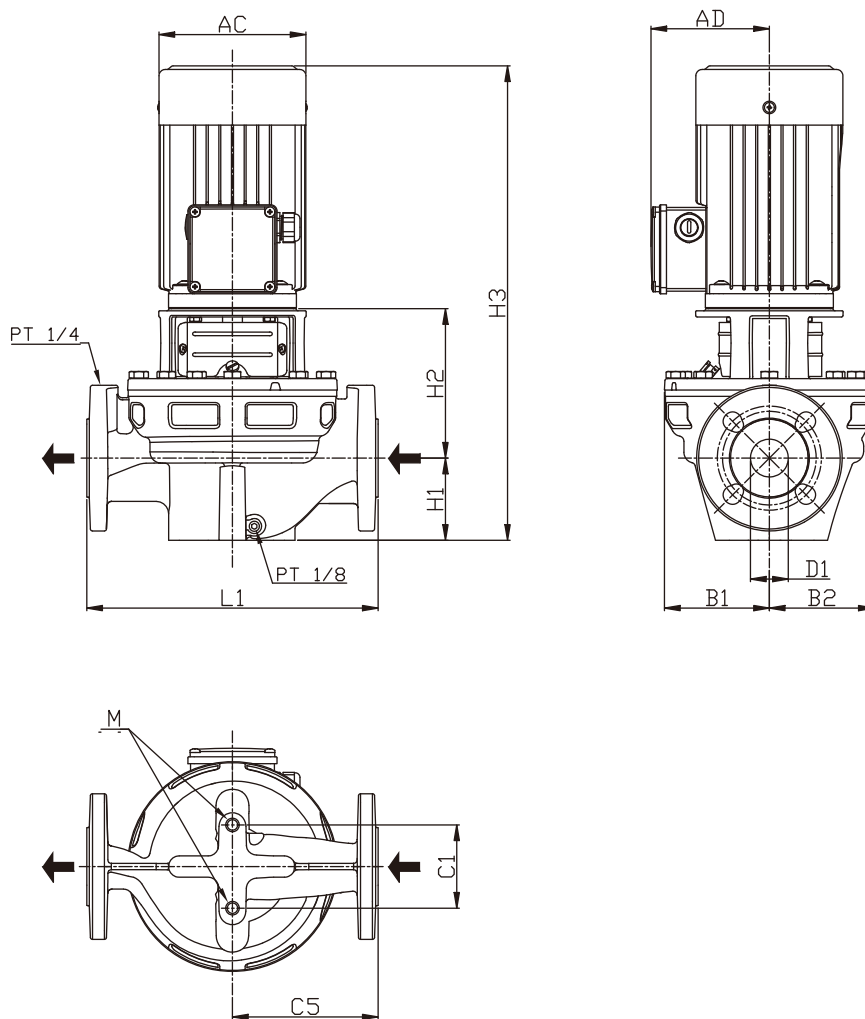

Model	Series	Flange		Dimension (mm)												Net Weight (kg)
		DIN	JIS	D1	AC	AD	B1	B2	C1	C5	L1	H1	H2	H3	M	
SLP 40-T-190-2	200	PN 16	10K	40	141	115	101	101	120	160	320	68	147	448	M12	27
SLP 40-T-230-2	200	PN 16	10K	40	141	115	101	101	120	160	320	68	147	468	M12	29
SLP 40-T-270-2	200	PN 16	10K	40	177	141	101	101	120	160	320	68	156	521	M12	36

\*The flange itself is not standard ANSI flange, but designed to be able to connect with ANSI flange.

Performance Curves

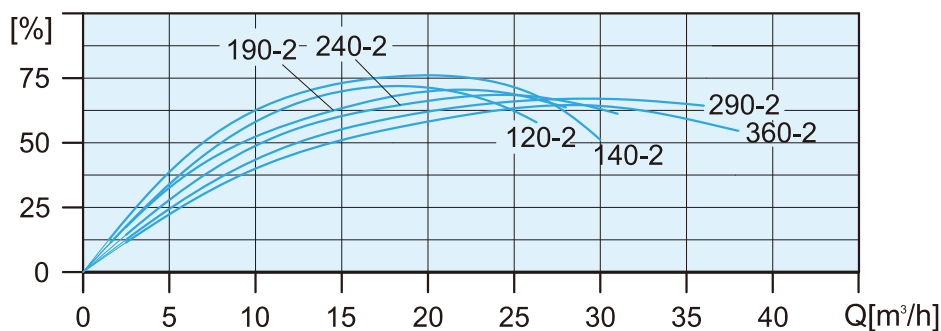
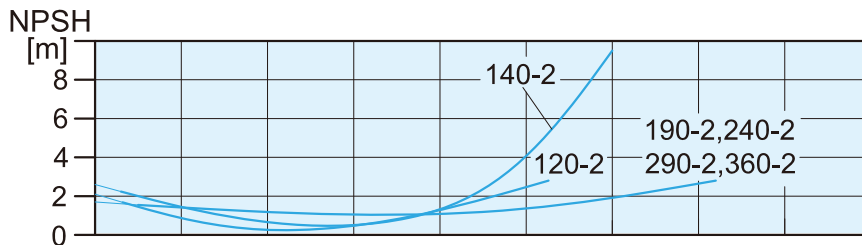
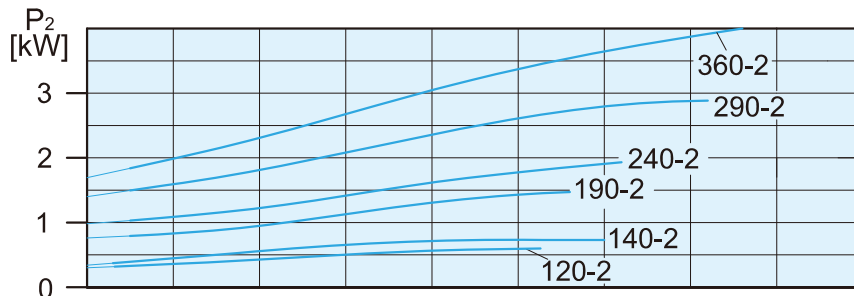
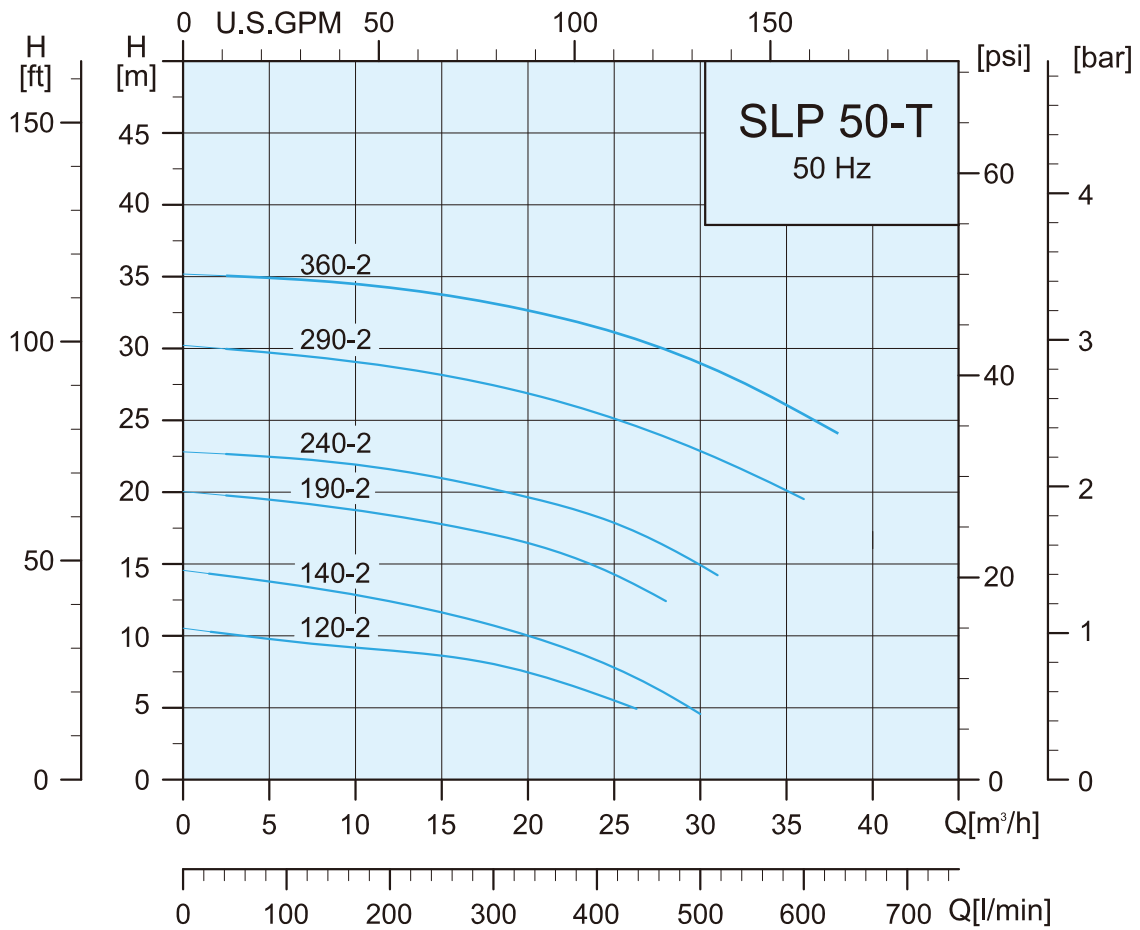

### Specifications

Model	Power		Head (Pressure)		Flow (Capacity)	Connection	T <sub>min</sub> / T <sub>max</sub>
	P <sub>2</sub>		Rated(m)	Max.(m)			
	kW	HP			Rated(m <sup>3</sup> /h)	Inlet / Outlet	°C
SLP 50-T-120-2	0.75	1.0	8.1	11.0	17.3	DN50	-25 / 120
SLP 50-T-140-2	0.75	1.0	10.2	14.0	18.3	DN50	-25 / 120

### Dimensions and Weights

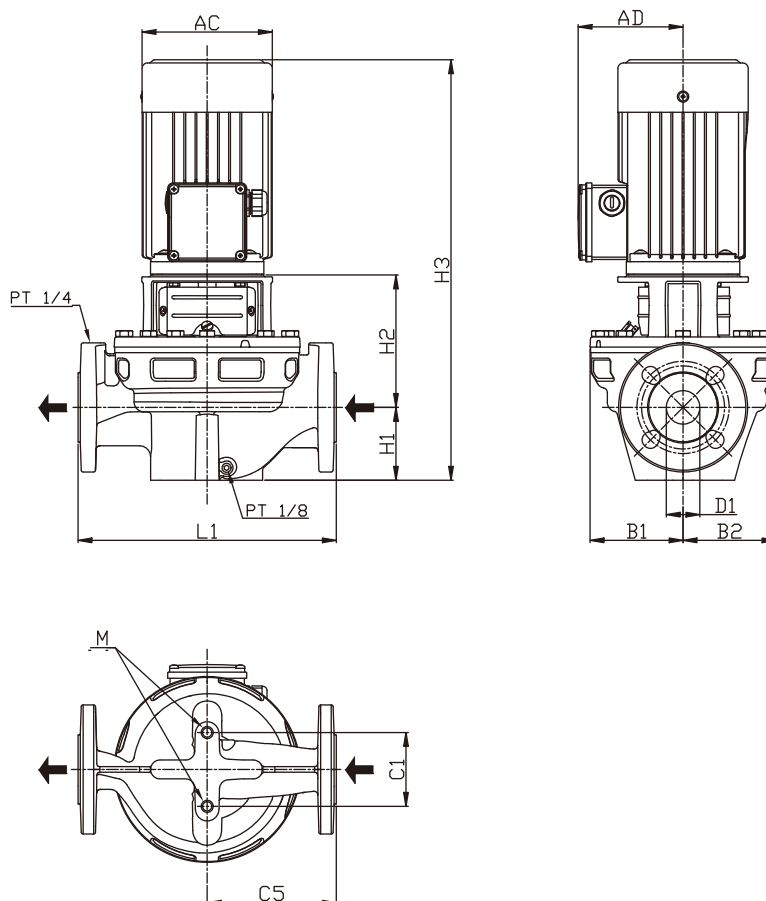

Model	Series	Flange		Dimension(mm)													Net Weight (kg)
		DIN	JIS	D1	AC	AD	P	B1	B2	C1	C5	L1	H1	H2	H3	M	
SLP 50-T-120-2	200	PN 6/10	10K	50	141	115	—	101	101	120	140	280	75	142	450	M12	26
SLP 50-T-140-2	200	PN 6/10	10K	50	141	115	—	101	101	120	140	280	75	142	450	M12	27

\*The flange itself is not standard ANSI flange, but designed to be able to connect with ANSI flange.

### Performance Curves

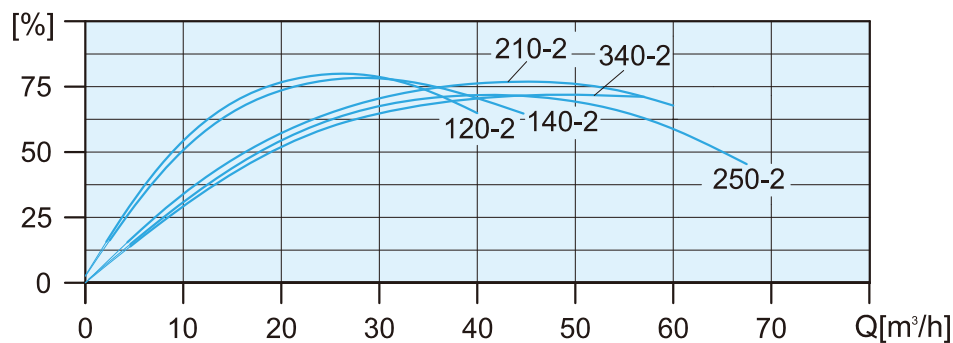
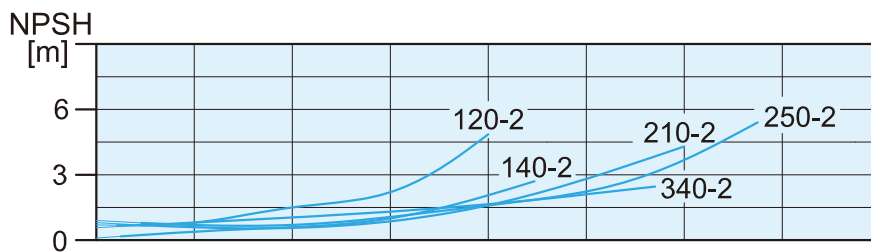
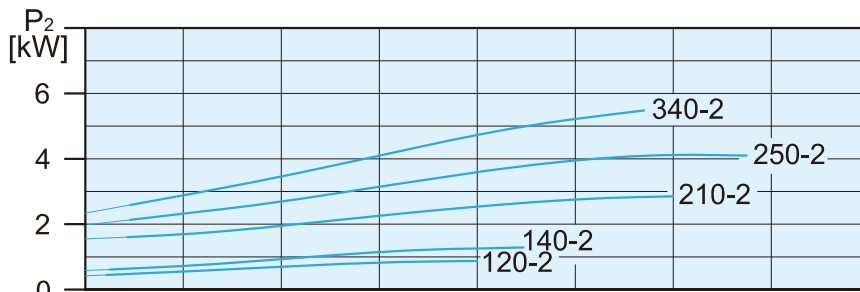
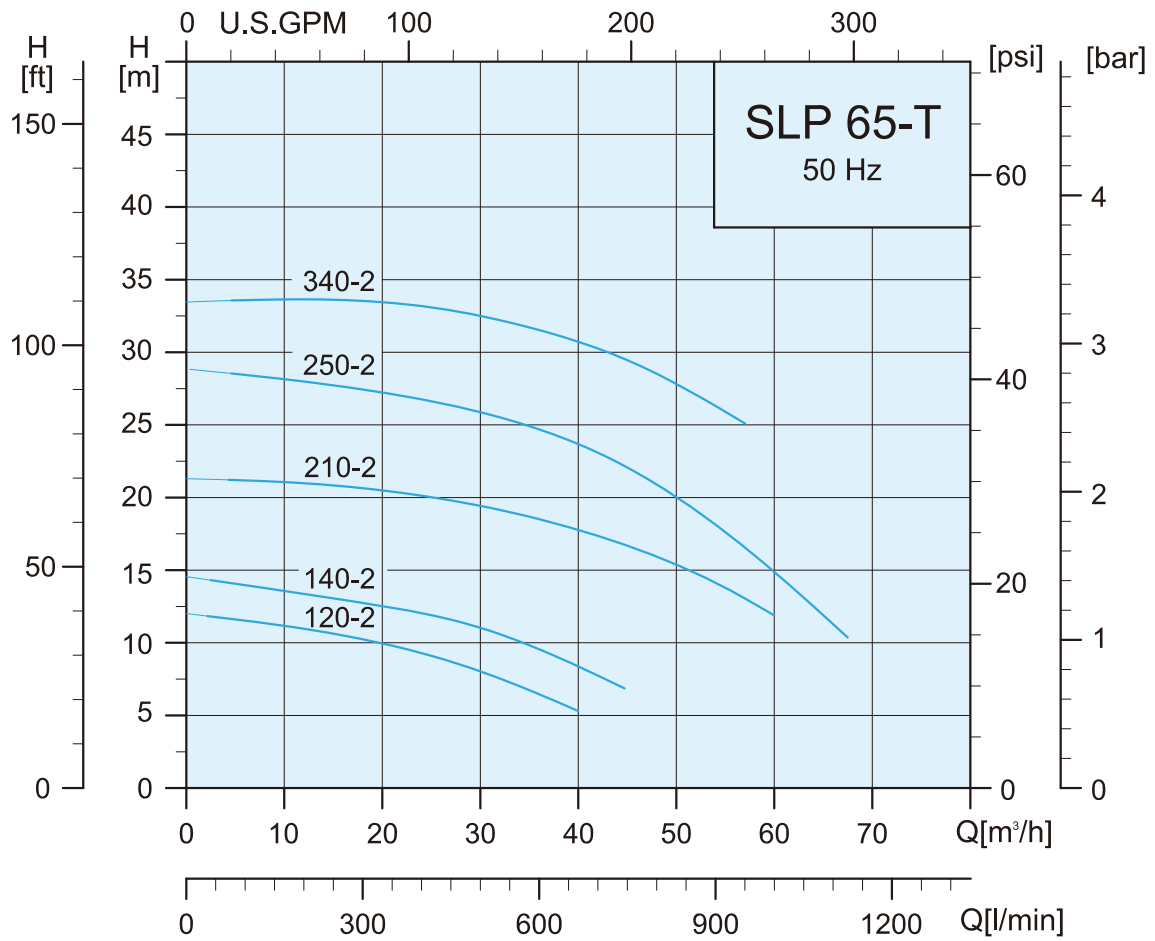

### Specifications

Model	Power		Head (Pressure)		Flow (Capacity)	Connection	T <sub>min</sub> / T <sub>max</sub>
	P <sub>2</sub>		Rated(m)	Max.(m)			
	kW	HP			Rated(m <sup>3</sup> /h)	Inlet / Outlet	°C
SLP 65-T-120-2	1.1	1.5	8.3	12.0	25.7	DN65	-25 / 120
SLP 65-T-140-2	1.5	2.0	11.4	14.0	28.0	DN65	-25 / 120

### Dimensions and Weights

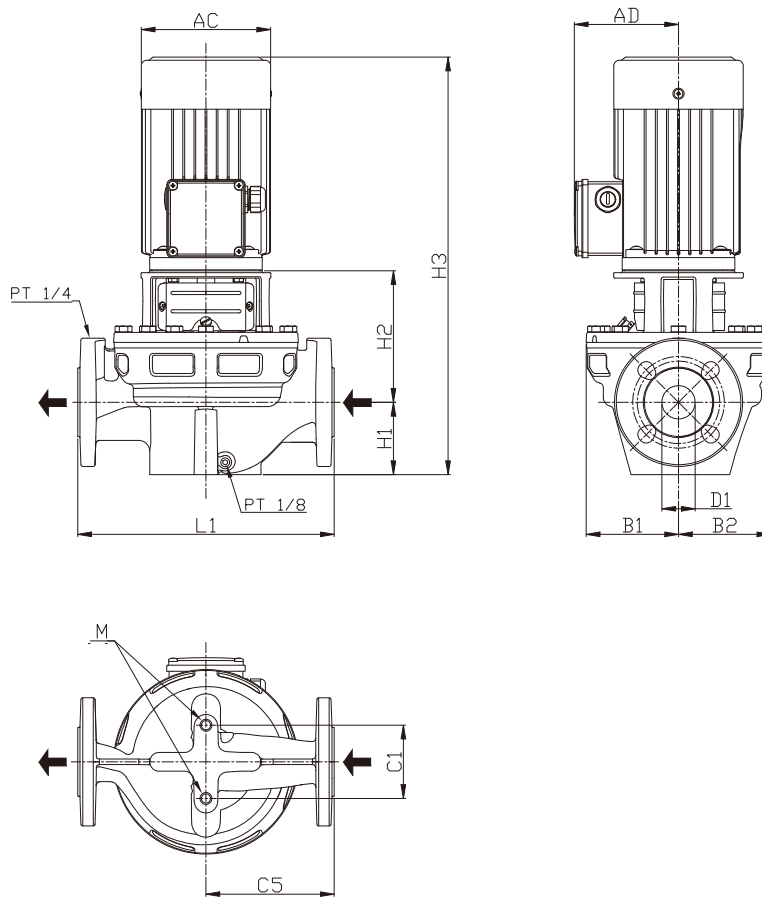

Model	Series	Flange		Dimension (mm)													Net Weight (kg)
		DIN	JIS	D1	AC	AD	P	B1	B2	C1	C5	L1	H1	H2	H3	M	
SLP 65-T-120-2	200	PN 6/10	10K	65	141	115	—	100	100	120	170	340	82	151	486	M12	32
SLP 65-T-140-2	200	PN 6/10	10K	65	177	141	—	100	100	120	170	340	82	160	539	M12	40

\*The flange itself is not standard ANSI flange, but designed to be able to connect with ANSI flange.

### Series 300 Materials

**Construction:**

SLP Series 300 pumps are single-stage, close-coupled pumps with in-line inlet and outlet ports of identical diameter.

The pumps are fitted with a fan-cooled asynchronous motor.

Motor and pump shafts are connected via a rigid sleeve coupling.

The pumps are of the top-pull-out design, that is you can remove the power head (motor, pump head and/or motor stool and impeller) or maintenance or service while the pump housing remains in the pipes. The pump housing is provided with a replaceable wear ring to ensure high pump efficiency for life.

The pumps are equipped with Two types of unbalanced mechanical shaft seals are available as standard RAQE

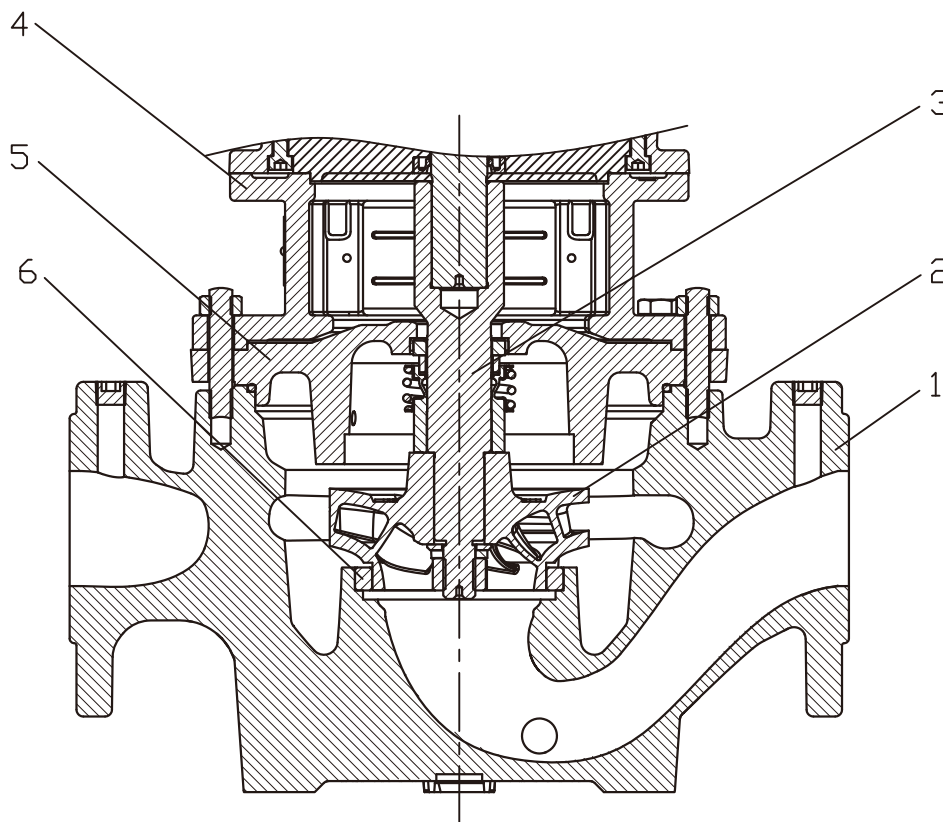

Pos.	Component	Material	EN/DIN
1	Pump housing	Cast iron FC250	0.6025
2	Impeller	Cast iron FC200	0.6020
3	Two-part stub shaft	Stainless steel / steel	1.4301 / 1.0301
4	Pump head	Cast iron FC250	0.6025
5	Pump head cover	Cast iron FC250	0.6025
6	Wear ring	Bronze CuSn10	2.1093
	Secondary seals	EPDM VITON	
	Rotating seal face	Carbon (Metal-impregnated) silicon carbide	
	Stationary seat	silicon carbide	

### Performance Curves

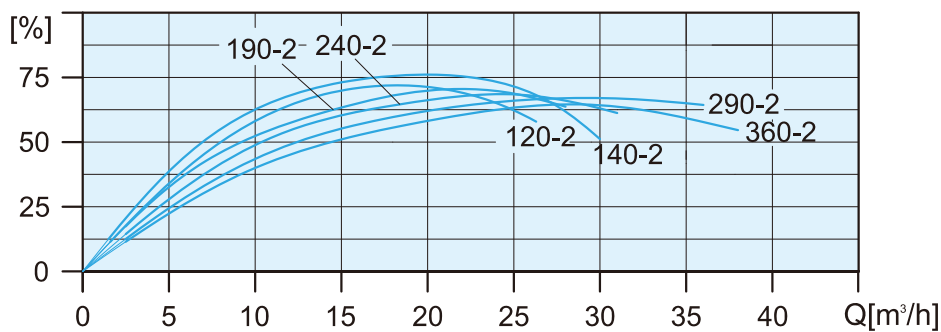
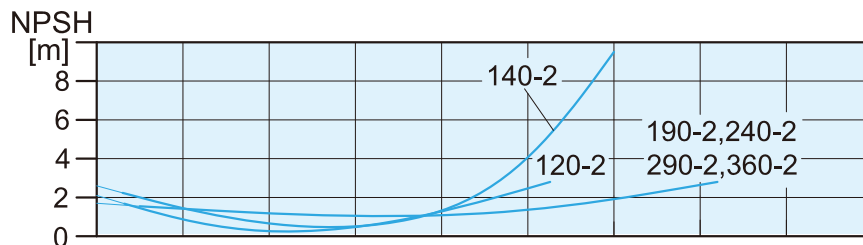
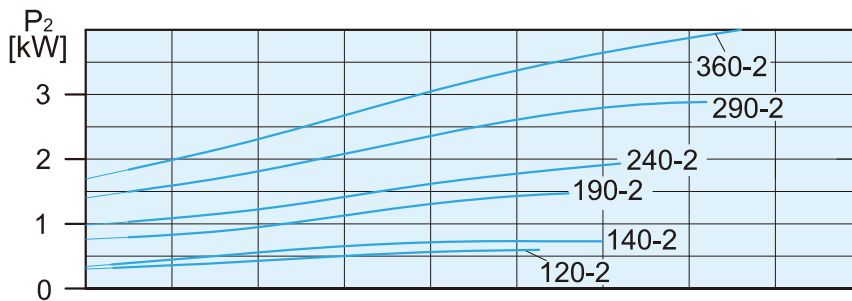
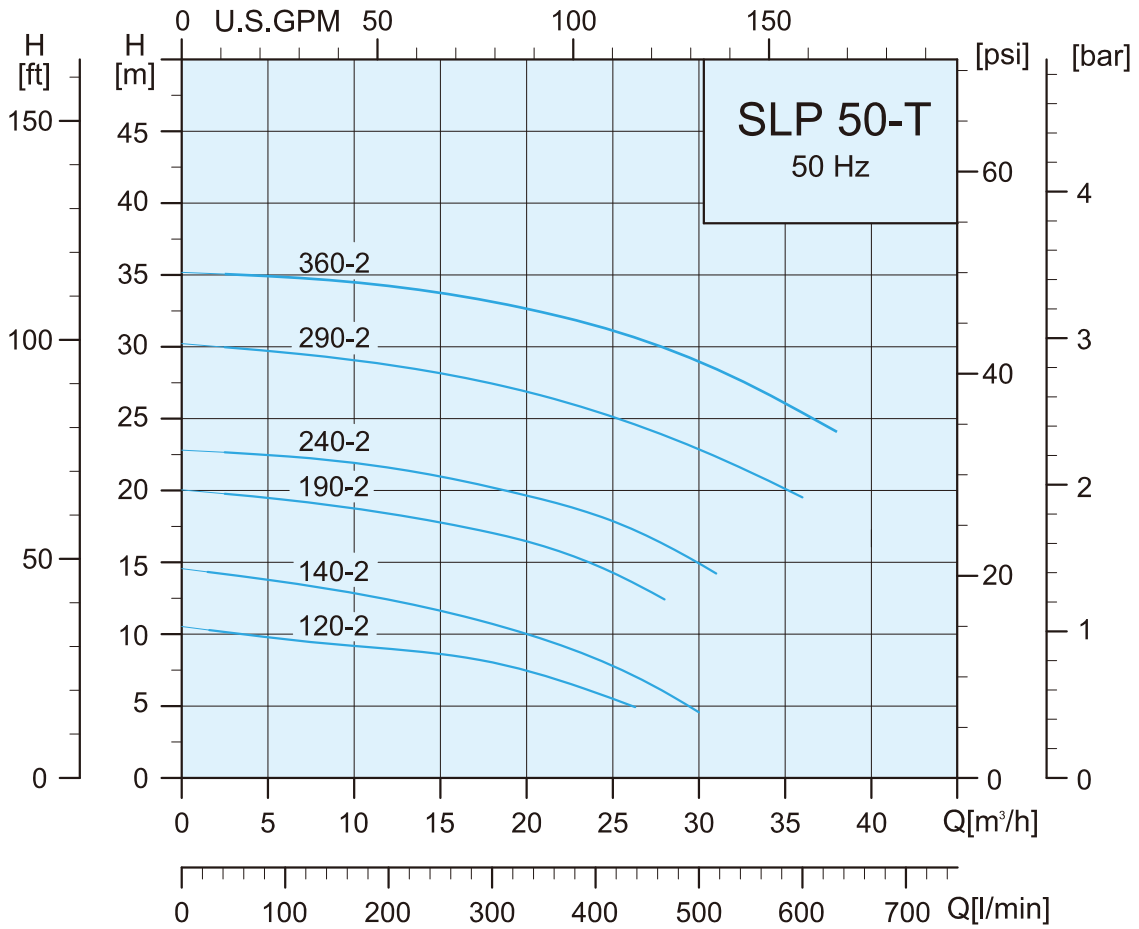

### Specifications

Model	Power		Head (Pressure)		Flow (Capacity)	Connection	T <sub>min</sub> / T <sub>max</sub>
	P <sub>2</sub>		Rated(m)	Max.(m)	Rated(m <sup>3</sup> /h)	Inlet / Outlet	°C
	kW	HP					
SLP 50-T-190-2	1.5	2.0	15.5	19.0	22.2	DN50	-25 / 120
SLP 50-T-240-2	2.2	3.0	18.6	23.0	24.1	DN50	-25 / 120
SLP 50-T-290-2	3.0	4.0	24.1	29.0	27.4	DN50	-25 / 120
SLP 50-T-360-2	4.0	5.5	28.2	35.0	31.3	DN50	-25 / 120

### Dimensions and Weights

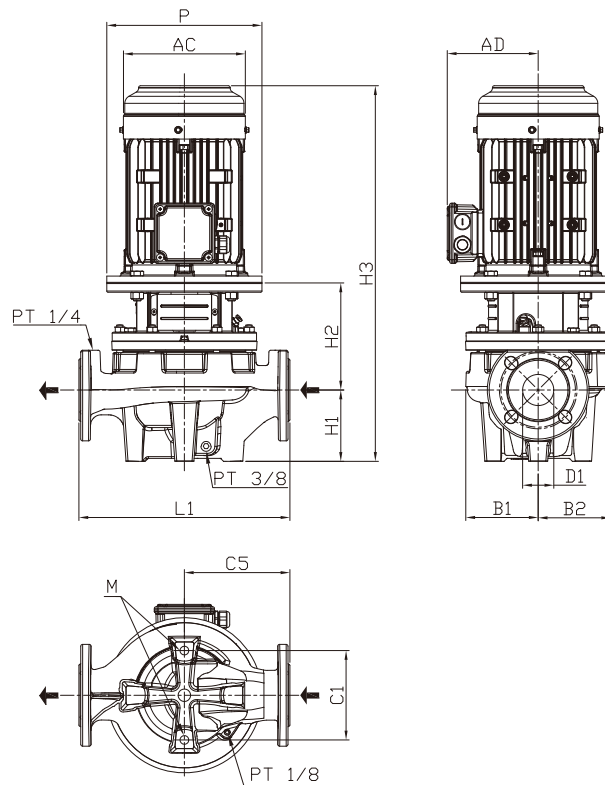

Model	Series	Flange		Dimension (mm)													Net Weight (kg)
		DIN	JIS	D1	AC	AD	P	B1	B2	C1	C5	L1	H1	H2	H3	M	
SLP 50-T-190-2	300	PN 16	10K	50	177	141	200	117	117	144	170	340	115	155	567	M16	56
SLP 50-T-240-2	300	PN 16	10K	50	177	141	200	117	117	144	170	340	115	155	567	M16	59
SLP 50-T-290-2	300	PN 16	10K	50	197	147	250	134	121	144	170	340	115	182	615	M16	66
SLP 50-T-360-2	300	PN 16	10K	50	220	161	250	134	121	144	170	340	115	182	623	M16	72

\*The flange itself is not standard ANSI flange, but designed to be able to connect with ANSI flange.

Performance Curves

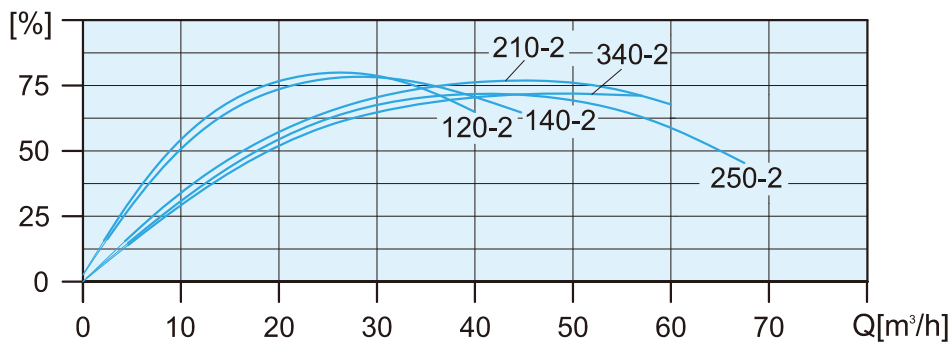
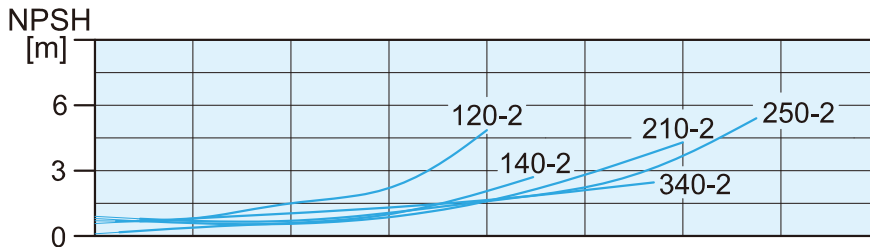
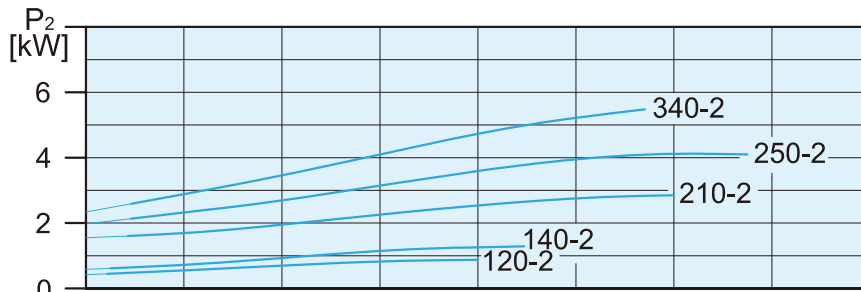
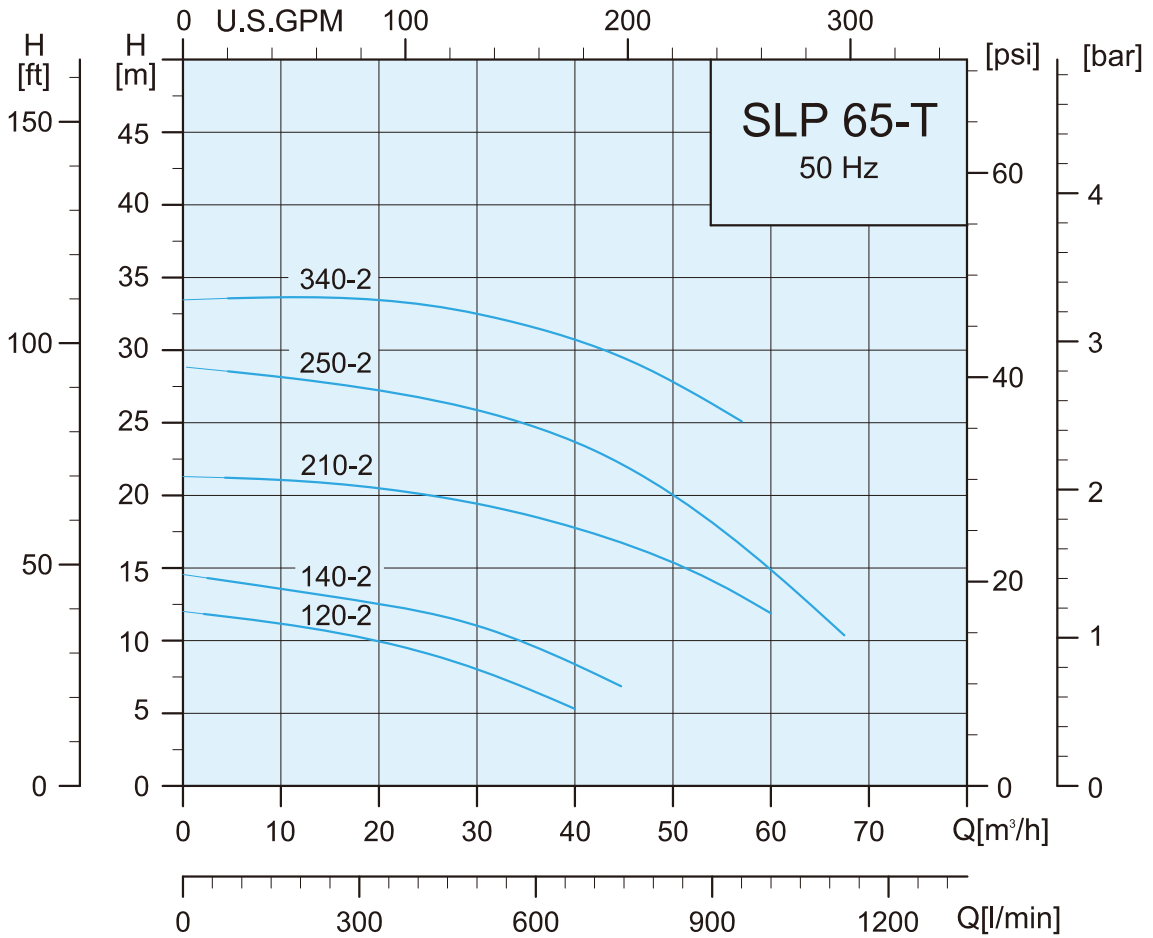

### Specifications

Model	Power		Head (Pressure)		Flow (Capacity)	Connection	T <sub>min</sub> / T <sub>max</sub>
	P <sub>2</sub>		Rated(m)	Max.(m)			
	kW	HP			°C		
SLP 65-T-210-2	3.0	4.0	16.8	21.0	46.3	DN65	-25 / 120
SLP 65-T-250-2	4.0	5.5	19.7	28.0	51.7	DN65	-25 / 120
SLP 65-T-340-2	5.5	7.5	28.0	33.0	49.1	DN65	-25 / 120

### Dimensions and Weights

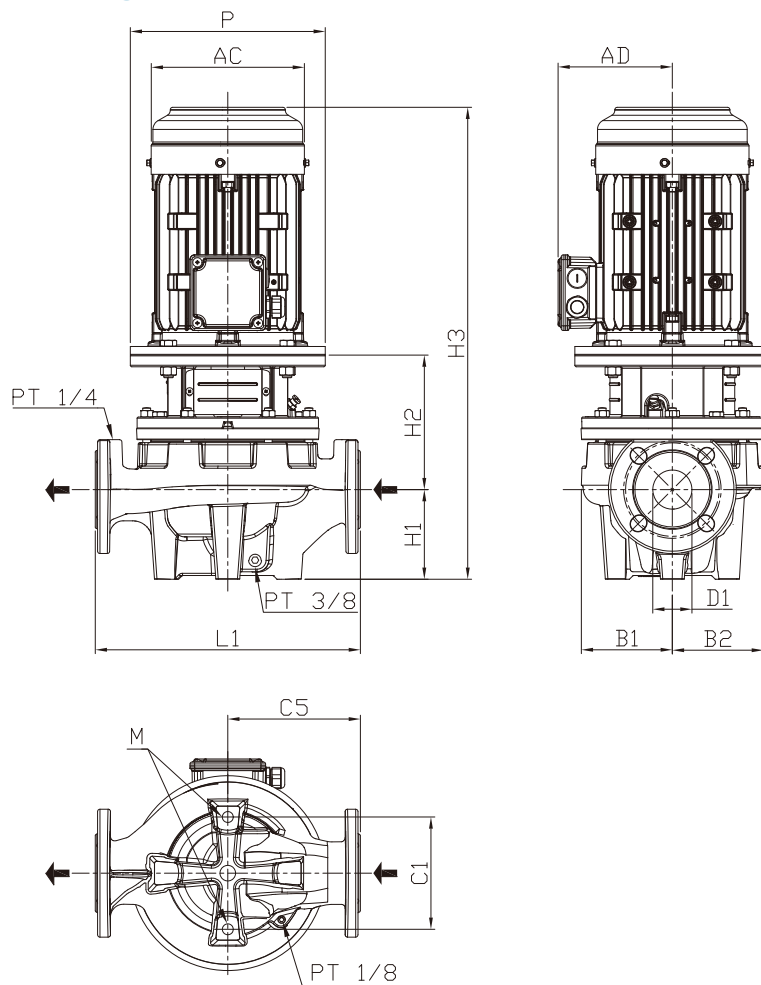

Model	Series	Flange		Dimension (mm)													Net Weight (kg)
		DIN	JIS	D1	AC	AD	P	B1	B2	C1	C5	L1	H1	H2	H3	M	
SLP 65-T-210-2	300	PN 16	10K	65	197	147	250	135	110	144	180	360	105	185	608	M16	68
SLP 65-T-250-2	300	PN 16	10K	65	220	161	250	142	123	144	180	360	105	193	624	M16	75
SLP 65-T-340-2	300	PN 16	10K	65	235	197	300	142	123	144	180	360	105	212	679	M16	92

\*The flange itself is not standard ANSI flange, but designed to be able to connect with ANSI flange.

Performance Curves

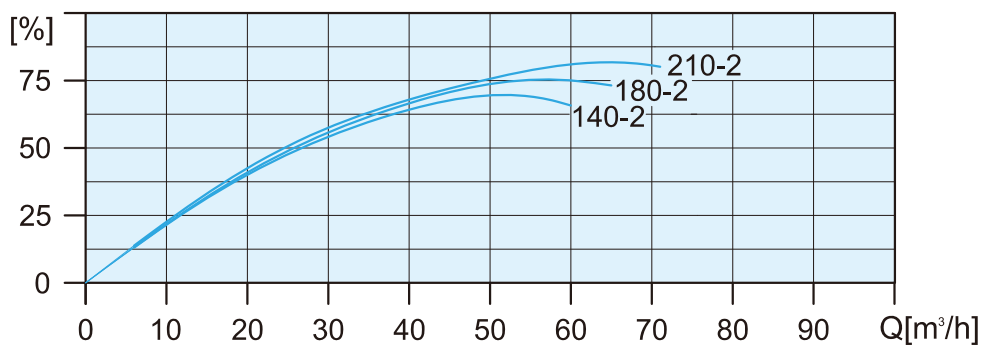
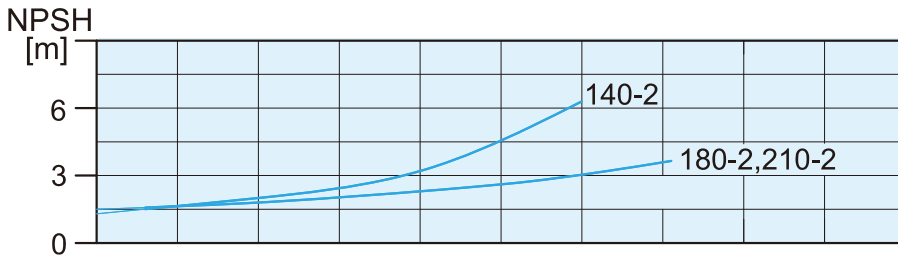
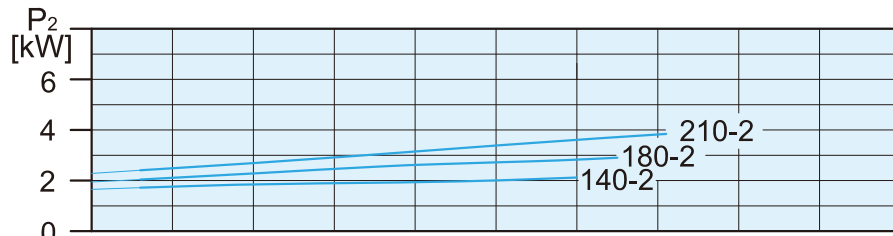
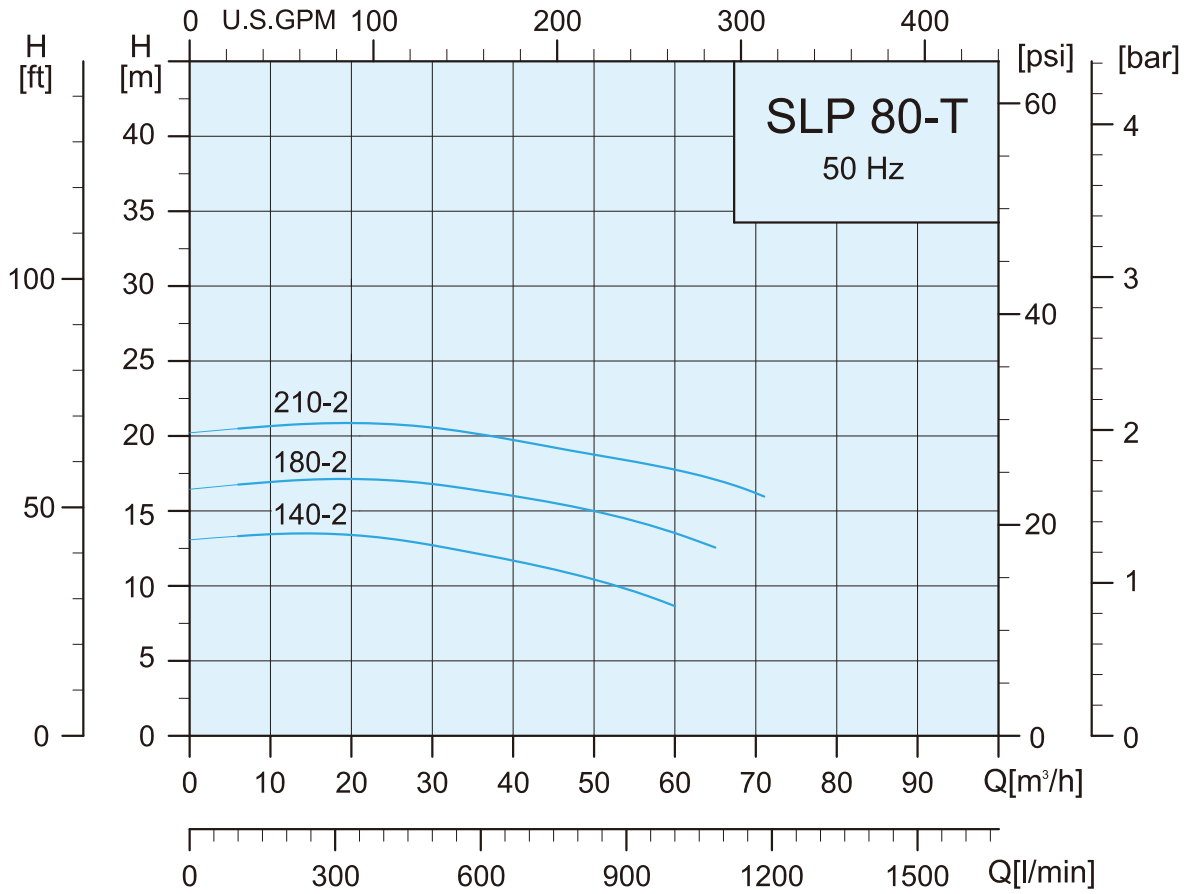

Performance Curves

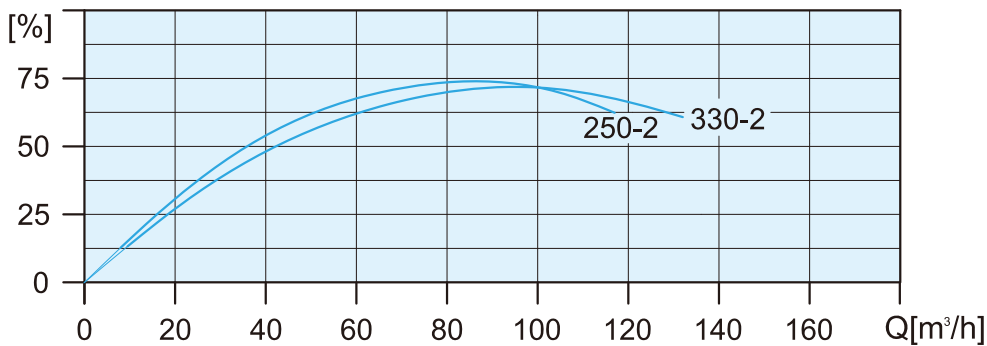
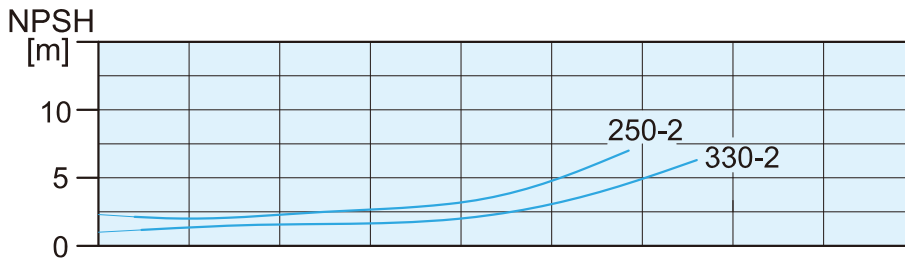
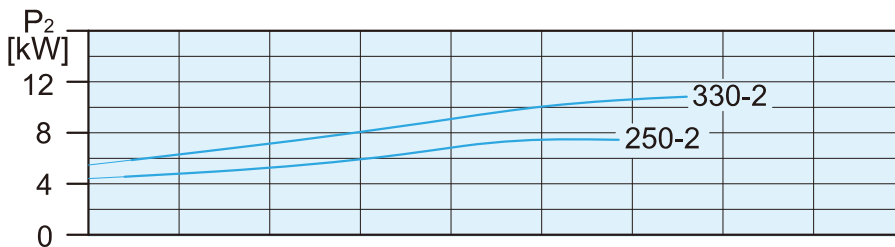
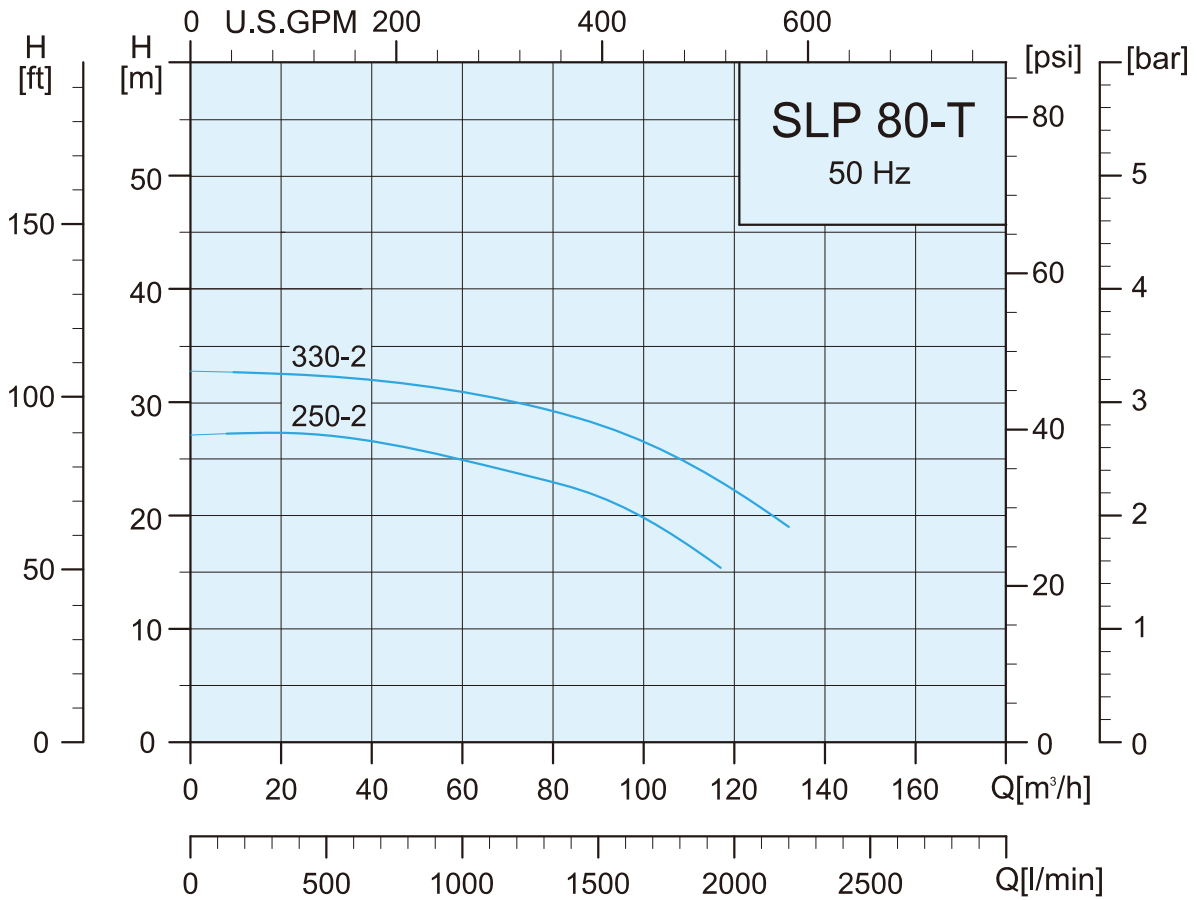

### Specifications

Model	Power		Head (Pressure)		Flow (Capacity)	Connection	T <sub>min</sub> / T <sub>max</sub>
	P <sub>2</sub>		Rated(m)	Max.(m)			
	kW	HP			Rated(m <sup>3</sup> /h)	Inlet / Outlet	°C
SLP 80-T-140-2	2.2	3.0	10.4	13.0	52.2	DN80	-25 / 120
SLP 80-T-180-2	3.0	4.0	13.7	17.0	57.8	DN80	-25 / 120
SLP 80-T-210-2	4.0	5.5	17.1	20.0	63.8	DN80	-25 / 120
SLP 80-T-250-2	7.5	10.0	21.7	27.0	90.4	DN80	-25 / 120
SLP 80-T-330-2	11.0	15.0	26.9	32.0	102.0	DN80	-25 / 120

### Dimensions and Weights

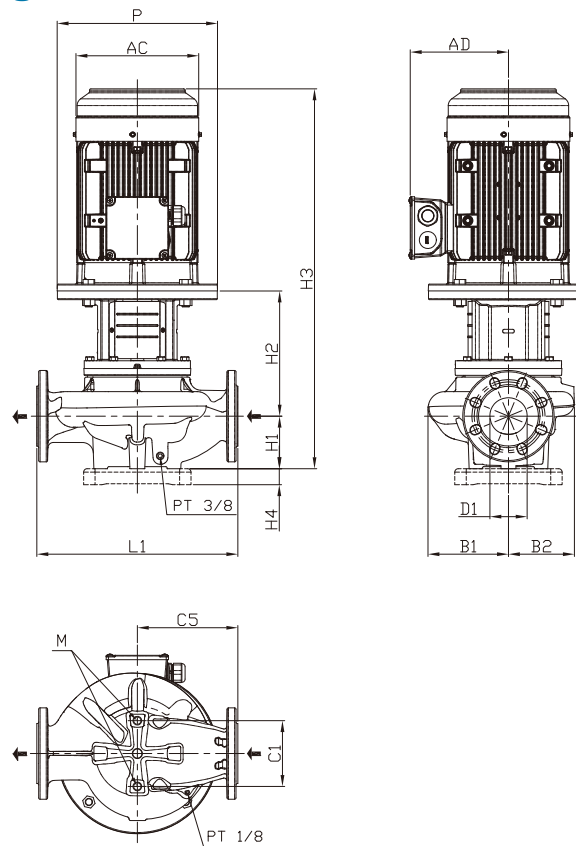

Model	Series	Flange		Dimension (mm)													Net Weight (kg)	
		DIN	JIS	D1	AC	AD	P	B1	B2	C1	C5	L1	H1	H2	H3	H4		M
SLP 80-T-140-2	300	PN 16	10K	80	177	141	200	135	123	144	180	360	105	179	581	—	M16	62
SLP 80-T-180-2	300	PN 16	10K	80	197	147	250	135	123	144	180	360	105	197	620	—	M16	72
SLP 80-T-210-2	300	PN 16	10K	80	220	161	250	135	123	144	180	360	105	197	627	—	M16	79
SLP 80-T-250-2	300	PN 16	10K	80	235	197	300	176	147	144	220	440	115	218	738	—	M16	110
SLP 80-T-330-2	300	PN 16	10K	80	269	215	350	176	147	144	220	440	115	274	832	35	M16	142

\*The flange itself is not standard ANSI flange, but designed to be able to connect with ANSI flange.

Performance Curves

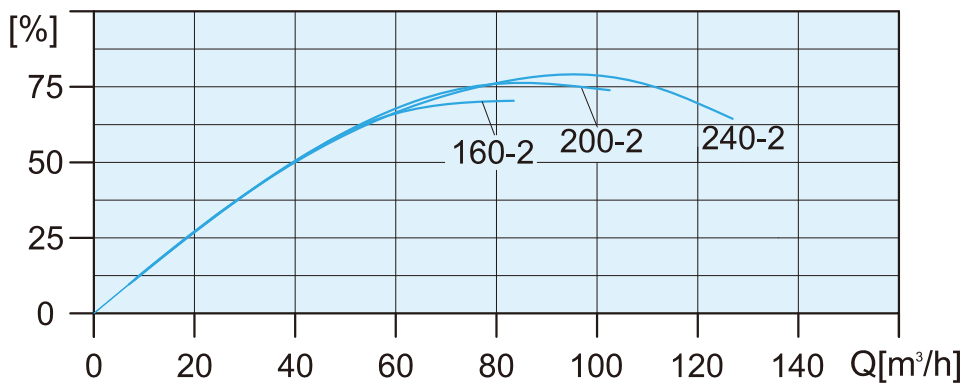
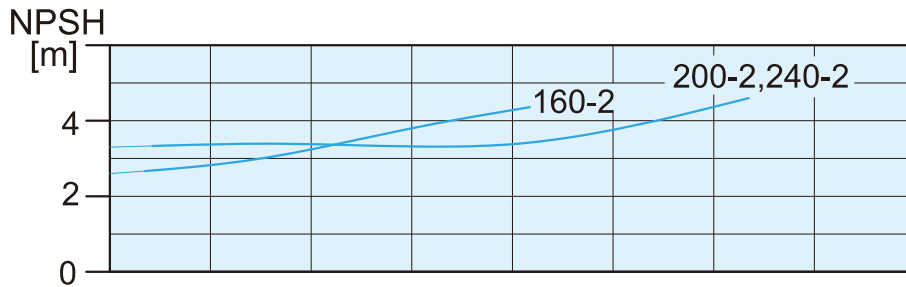
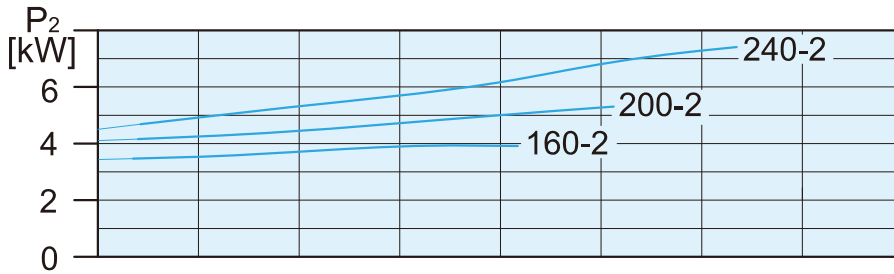
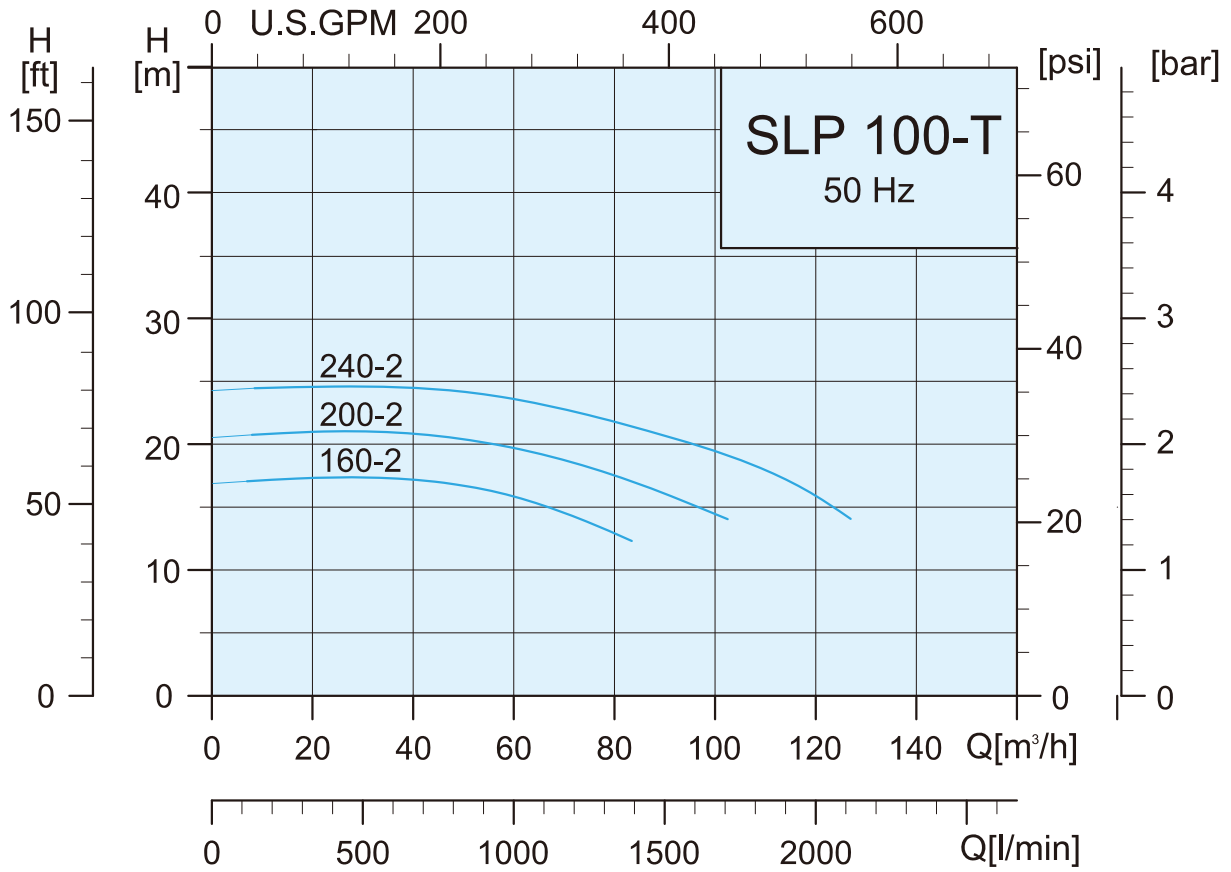

Specifications

Model	Power		Head (Pressure)		Flow (Capacity)	Connection	T <sub>min</sub> / T <sub>max</sub>
	P <sub>2</sub>		Rated(m)	Max.(m)	Rated(m <sup>3</sup> /h)		Inlet / Outlet
	kW	HP					
SLP 100-T-160-2	4.0	5.5	12.8	16.0	76.2	DN100	-25 / 120
SLP 100-T-200-2	5.5	7.5	16.7	20.0	85.2	DN100	-25 / 120
SLP 100-T-240-2	7.5	10.0	20.3	24.0	94.5	DN100	-25 / 120

Dimensions and Weights

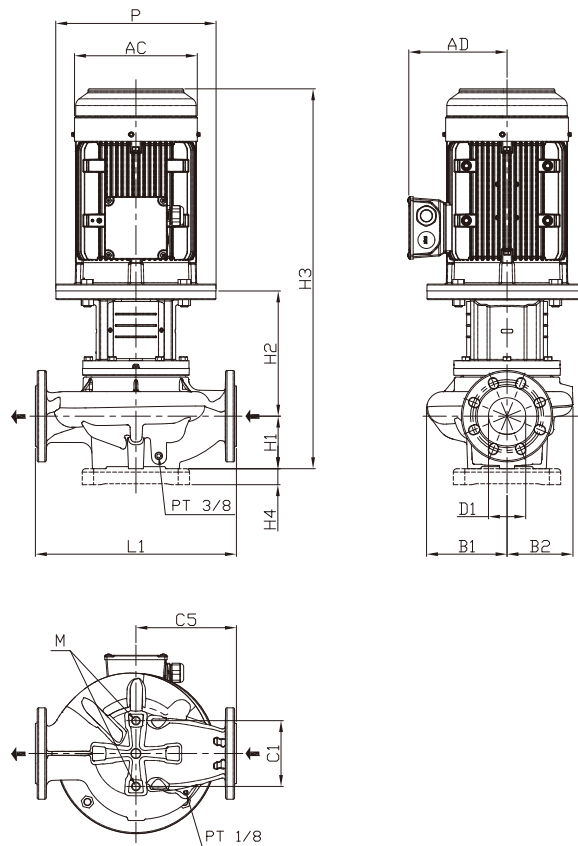

Model	Series	Flange		Dimension (mm)														Net Weight (kg)
		DIN	JIS	D1	AC	AD	P	B1	B2	C1	C5	L1	H1	H2	H3	H4	M	
SLP 100-T-160-2	300	PN 16	10K	100	220	161	250	157	127	144	250	500	140	199	665	—	M16	94
SLP 100-T-200-2	300	PN 16	10K	100	235	197	300	157	127	144	250	500	140	218	720	—	M16	110
SLP 100-T-240-2	300	PN 16	10K	100	235	197	300	157	127	144	250	500	140	218	763	—	M16	117

\*The flange itself is not standard ANSI flange, but designed to be able to connect with ANSI flange.







 **STAIRS**

No.6-7-1,Shanzijiao, Lucao Township, Chiayi County 61158, Taiwan  
Tel: +886 5 3750488 Fax: +886 5 3755658  
[www.stairs.com.tw](http://www.stairs.com.tw) E-mail:[stairs@stairs.com.tw](mailto:stairs@stairs.com.tw)

1140318

